

## NEON | IP67 SNAP CONNECTION INSTRUCTIONS



Connector 01 / 02

End cap 01 / 02

Flex connector

Snap connection installation guide shows example for Neon Edge Connector 01. Technique is the same for connectors and end caps for all the Neon range (excluding Arc).

### NOTE

- Connections must be fitted to strip correctly for IP67 rating.
- Never wet the assembly units or assemble with wet hands.

### Components

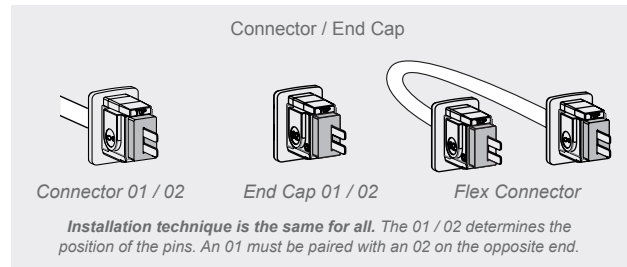
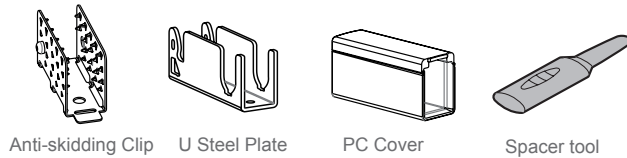

### Exploded View

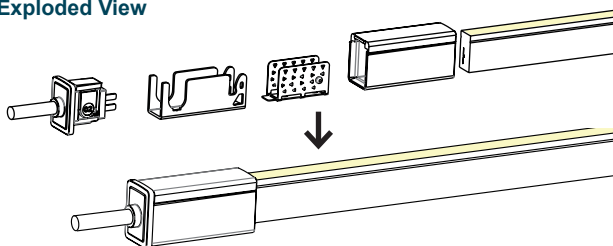

### Step 1: General Connector/End cap information

- A standard setup will use a connector 01 or 02 at one end, and an end cap 01 or 02 at the opposite end.
- For a double power feed (to increase max run length) use connectors 01 and 02 at opposite ends.
- The connectors/end caps have an 01 or 02 marked on them. Flex connectors have both 01 and 02 connections to join Neon strip together.

### Step 2: Place PC Cover over strip

- Place PC cover over strip, paying attention to the direction marked on the bottom of the PC cover.

CONNECTION END TO BE WORKED ON

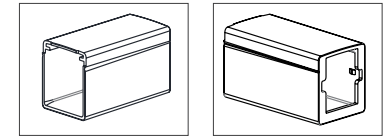
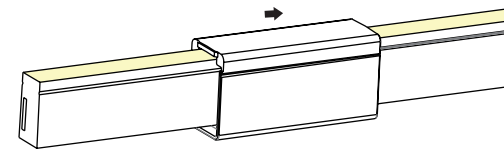

SNAP END OF PC COVER REAR END OF PC COVER

### Step 3: Use Spacer tool to create a cavity on the backside of the PCB strip

- Insert the spacer tool to the **backside of PCB** around 10–12mm, move the spacer up and down 3–5 times gently to create a small cavity. This is where the connector/end cap pins will insert.

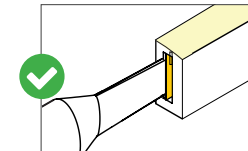
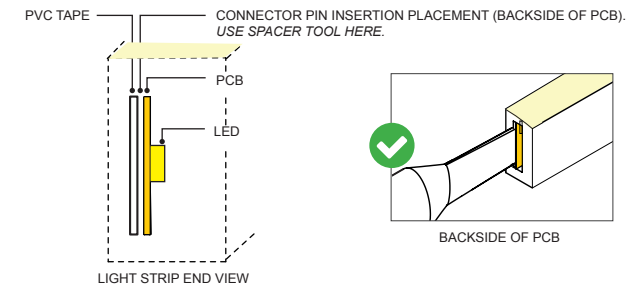
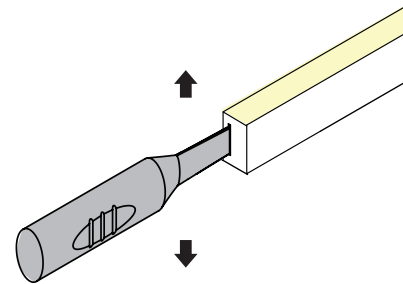

BACKSIDE OF PCB

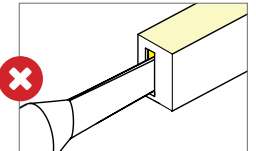

NEVER INSERT SPACER TOOL TO THE FRONT SIDE OF PCB AS THIS CAN DAMAGE THE LEDs.

### Step 4: Inserting the Connector/End cap (MAKE SURE CONNECTION END HAS BEEN CUT STRAIGHT)

- Insert the connector/end cap pins into backside of PCB strip, leaving a 2-5mm gap.

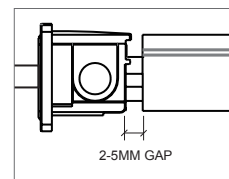

2-5MM GAP

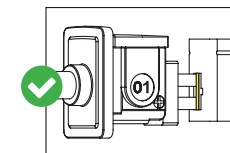
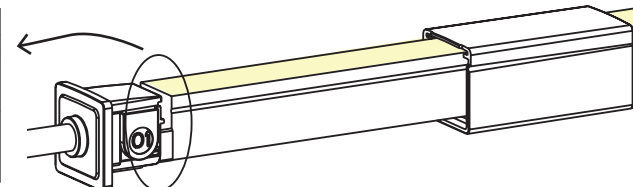

INSERT TO BACKSIDE OF PCB

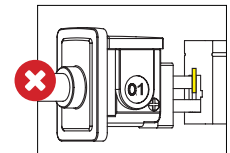

NEVER INSERT CROSS WISE INTO THE PCB

## NEON | IP67 SNAP CONNECTION INSTRUCTIONS

### Step 5: Installation of Anti-skidding clip

- Unfold the Anti-skidding clip about 20 degrees on both sides.

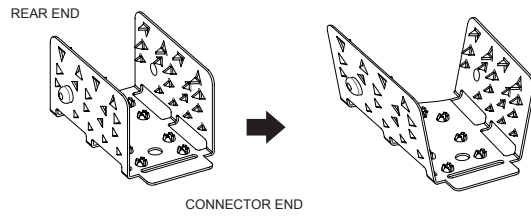

- Place the Anti-skidding clip onto the connection end of the light strip. Make sure you pay attention to its direction and align it with the cut edge on both sides.

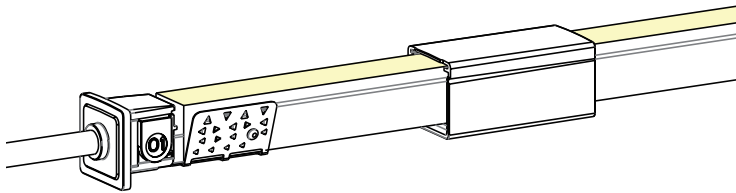

- Fit the Anti-skidding clip to the end of the strip so that wraps rightly.

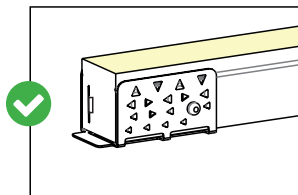
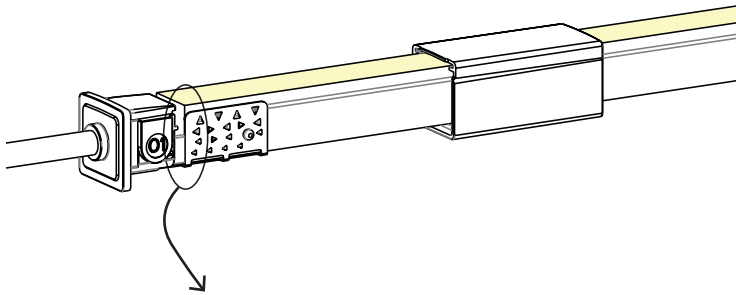

ALIGNED ANTI-SKIDDING CLIP WITH THE CUT EDGE ON BOTH SIDES

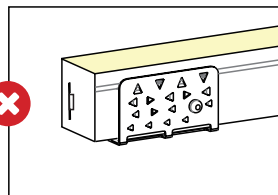

NOT ALIGNED TO CUT EDGE

### Step 6: Installation of U steel plate and PC cover

- Align the connector/end cap and anti-skidding clip with the U steel plate.

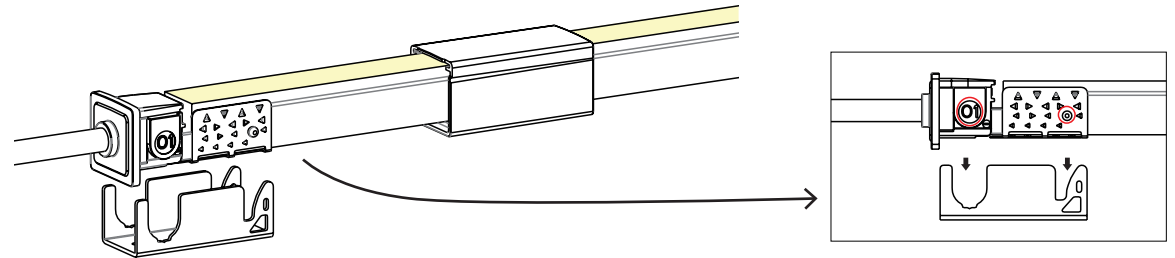

- Press the connector/end cap and light strip downwards at the same time until its clipped into place. This will close the gap between connector and light strip.

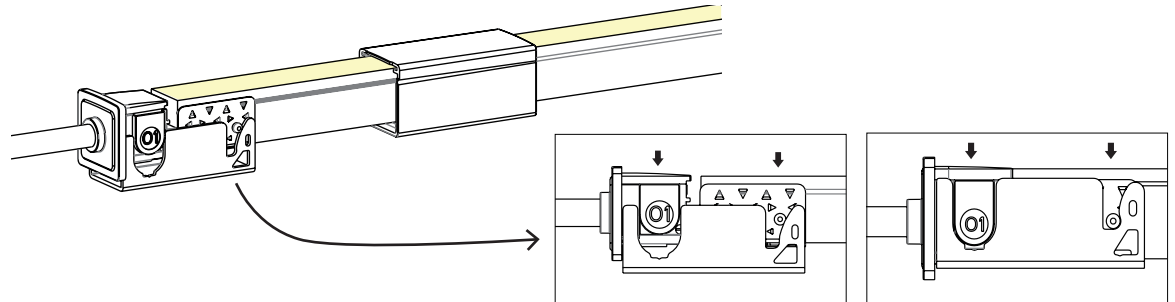

- Slide back the PC cover till it snaps into the connector/end cap.

